

S6006

01-04 CHEV/GMC 2500/3500 6.6L
DURAMAX, DOWN PIPE BACK, EC/CC,
OFF-ROAD, COOL DUALS®

MBRP

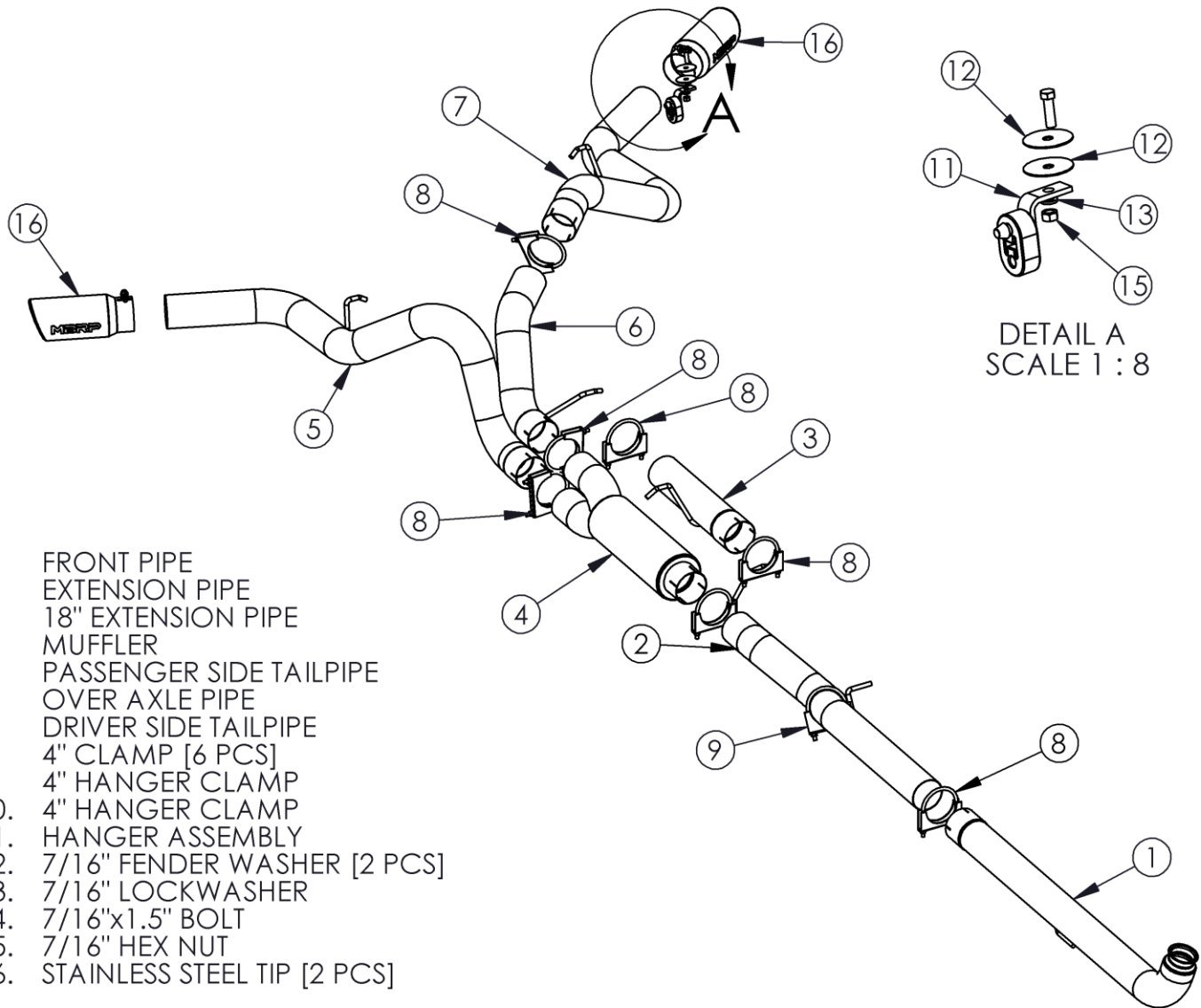

DETAIL A
SCALE 1 : 8

1. FRONT PIPE
2. EXTENSION PIPE
3. 18" EXTENSION PIPE
4. MUFFLER
5. PASSENGER SIDE TAILPIPE
6. OVER AXLE PIPE
7. DRIVER SIDE TAILPIPE
8. 4" CLAMP [6 PCS]
9. 4" HANGER CLAMP
10. 4" HANGER CLAMP
11. HANGER ASSEMBLY
12. 7/16" FENDER WASHER [2 PCS]
13. 7/16" LOCKWASHER
14. 7/16"x1.5" BOLT
15. 7/16" HEX NUT
16. STAINLESS STEEL TIP [2 PCS]

PLEASE READ BEFORE STARTING INSTALLATION

While MBRP Inc. has made every effort to ensure that all components of this system are of superior quality and properly packaged, it is the installer's responsibility to ensure the following before removal of the factory exhaust:

- that ALL components shown above are present.
- that ALL mating components fit together.
- that there are no damaged components.
- that the system you have purchased is appropriate for your vehicle year, model and configuration.
- that the system will not interfere with any modifications previously installed or planned.
- that you have read and understand these instructions.

If you have any questions or are uncertain about any aspect of the installation of this system to your vehicle please contact your dealer before commencing installation.

MBRP

Removal of Stock System:



Figure 1



Figure 2



Figure 3

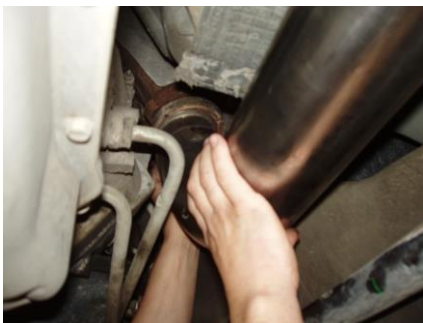

Figure 4

1. Apply penetrating lubricant liberally to all exhaust fasteners, hangers and rubber insulators.
2. Disconnect the factory exhaust system at the four bolt flange located behind the catalytic converter. If the vehicle is not equipped with a catalytic converter disconnect the four bolt flange located approximately under the passenger seat. See Figure 1.
3. Remove the exhaust system from the rubber insulators and remove from under the vehicle. If a hoist is not available for use it may be necessary to cut the tail pipe behind the muffler for removal of the system.
4. Unbolt the OEM hanger from the transmission and remove. Do not discard the hanger as it is required for the installation. See Figure 2.
5. Loosen the factory band clamp and remove the stock front pipe. See Figure 3. Do not discard the band clamp as it is required for the installation.

MBRP

Installation of MBRP Performance Exhaust:



Figure 5



Figure 6



Figure 7



Figure 8



Figure 9

1. Install the Front Pipe onto the factory down pipe using the band clamp removed previously. Do not fully tighten to allow for adjustment. See Figure 4.
2. Install the hanger removed previously by sliding the outside hole in the rubber insulator over the hanger on the Front Pipe and re-connect to the transmission. See Figure 5.
3. Connect the Extension Pipe to the Front Pipe at the slip joint placing the bend around and under the cross member. Rotate the Extension Pipe to position the bend towards the driveshaft. See Figure 6. The Extension Pipe does not require cutting to fit Crew Cab trucks. For Extended Cab trucks, approximately 9 ½" needs to be cut off the end with the shortest straight section of pipe. (Installation tip: Temporarily hang the Muffler and Passenger Side Tail Pipe in place and measure to the four bolt flange to verify the length required).
4. Position the Extension Pipe as shown and loosely install the Hanger Clamp with the shortest hanger. See Figure 7. This will support the Extension Pipe during the Muffler installation.
5. Crew Cab & Extended Cab long box trucks require the use of the 18" Extension Pipe provided. This is to be positioned between the Muffler and the Extension Pipe. See Figure 8. The 18" Extension Pipe is not required with short box trucks.
6. Install the Muffler on the Extension Pipe. The Muffler outlets will be positioned vertically when installed. See Figure 9.

MBRP

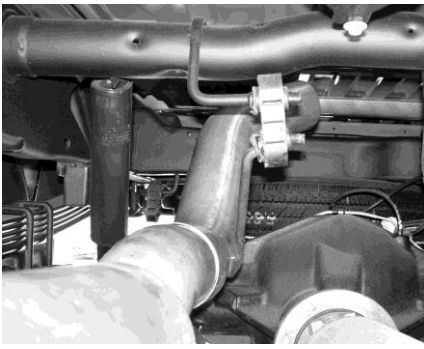

Figure 10



Figure 11



Figure 12



Figure 13

7. Install the Over Axle Pipe onto the top outlet of the Muffler and install the hanger into the OEM rubber hanger located above the Muffler. Adjust for maximum axle clearance. See Figure 10.
8. Install the Driver Side Tailpipe by feeding it around the outside of the shock absorber and connecting it to the Over Axle Pipe. Adjust for maximum clearance around shock absorber. See Figure 11.
9. Using the factory hole located in the frame, found directly above the tail pipe hanger, attach the Rubber Hanger provided using the supplied hardware. See Figure 12. Hang the Driver's Side Tailpipe from the installed Rubber Hanger.
10. Install the Passenger Side Tail Pipe from the rear of the truck, over the axle and attach to the lower outlet of the Muffler. Install the tail pipe hanger into the OEM hanger and adjust for maximum axle clearance to complete. See Figure 13.
11. Install the remaining Clamps around pipes as shown in the opening diagram. Adjust the Tailpipes and check along the whole length of the exhaust system to ensure that there is adequate clearance around the spare tire, fuel and brake lines or any wiring. If any interference is detected, relocate or adjust.
12. Make sure the exhaust is properly aligned before tightening clamps. Start at the front of the exhaust system and begin tightening all connections.
13. Install and adjust Tips to suit.

Congratulations! You are ready to begin experiencing the improved power, sound and driving excitement of your **MBRP** performance exhaust system. We know you will enjoy your purchase.